



IMPORTANT SAFETY PRECAUTIONS

Basic safety precautions should be followed when using electrical appliances, especially when there are children.

In order to avoid electric shock follow the following rules:

- Before cleaning the electrical appliance, unplug it from the mains.
- Do not use the electrical appliance in a bath or shower. Do not drop it into water or other liquids.

Do not touch an electrical appliance that has fallen into the water! Unplug it immediately.

In order to prevent a burn, fire, or injury:

- Use this appliance only for the purposes described in this operations manual. Do not use devices that are not recommended by the manufacturer.
- Never leave this electrical appliance plugged in unattended.
- When an electrical appliance is used by children or persons with disabilities, it must be carefully supervised.
- Never operate the electrical appliance if the cord or plug is damaged.
- Keep the cord away from hot surfaces. Do not pull or bend the cord. Do not wrap it around the electrical appliance.
- Do not drop the electrical appliance. Do not insert foreign objects into its holes.
- Make sure that the blades are properly adjusted before using this appliance.

Warranty obligations:

1. The manufacturer guarantees the operation of the product under the conditions of transportation, storage, and operation.
2. The warranty covers all damage to the product probably caused by a manufacturing defect.
3. The warranty does not cover mechanical damage to the product.
4. The warranty period of the product is 12 months from the date of sale.

The warranty does not cover the following products:

- Products, if malfunctions in them have arisen as a result of the violation of the rules of operation and transportation.
- Damage caused by overuse, improper handling, improper storage or maintenance, and improper blade removal.
- Components worn out during operation and having a limited service life (POWER CORDS, brushes, plastic leashes, etc.)
- Damage caused by getting foreign objects, substances, and insects in.
- Self-repair of the product or repair carried out in non-specialized workshops.

The consumer loses the warranty service rights in the following cases:

- at the expiration of the warranty period;
- in the presence of mechanical damage to the outer parts of the product;
- in case of violation of the rules of operation.

Cleaning and lubrication of products and sharpening of blades after any period of operation are not included in the cost of warranty service.

You must show the documents certifying the purchase of this product, this product manual with the signature of the seller, and the stamp of the trading organization to get the warranty repair.

« _____ » _____ 20__ year

« _____ » _____ 20__ year

Seller Signature

Seller Signature

Place for stamp

Place for stamp

MUSTANG

Shaver ROAD MJS-02

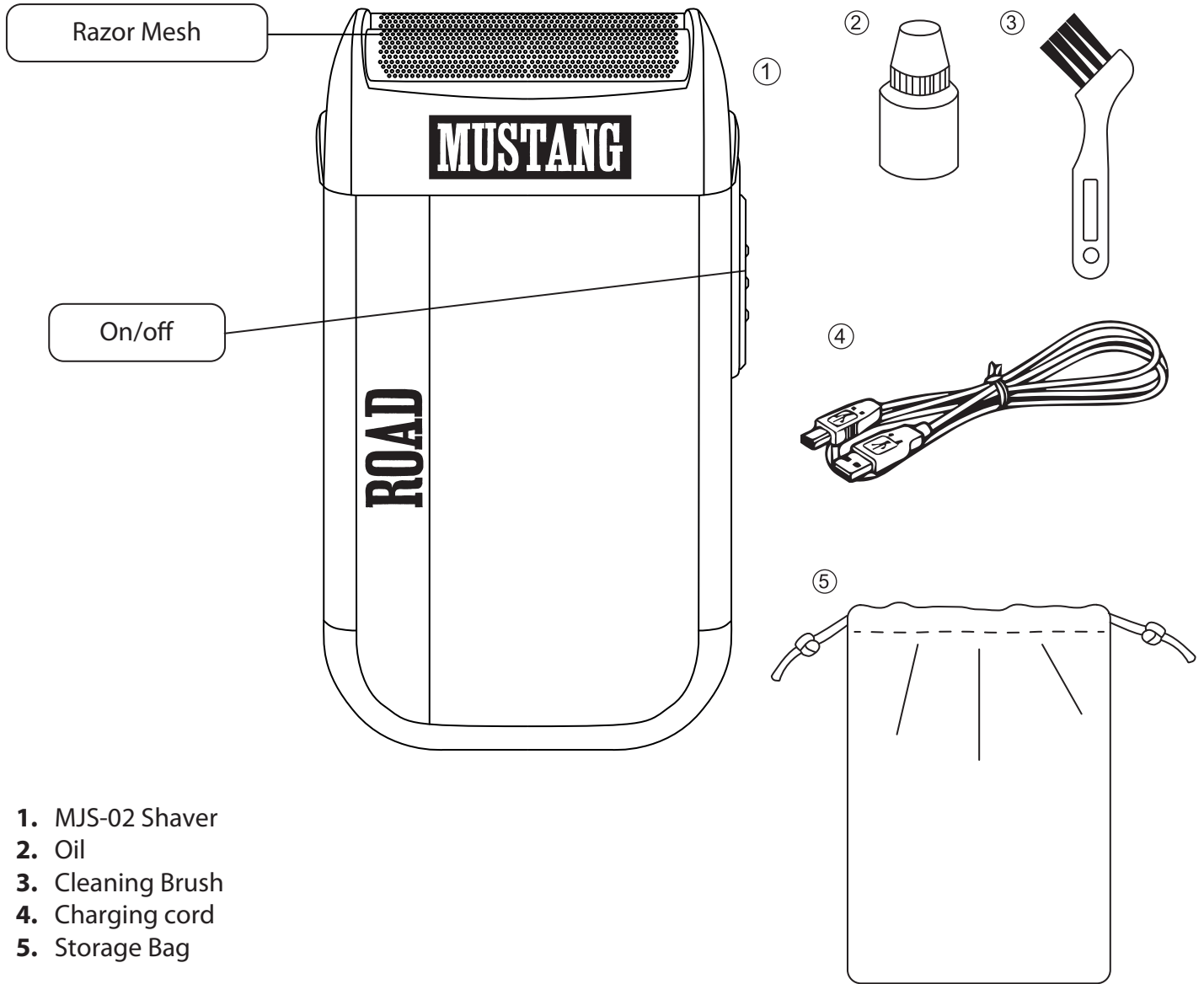

TECHNICAL SPECIFICATIONS

Hair clipper	Motor	Working voltage: 5 V Motor rotation speed: 6600 rpm
	Battery	Battery capacity: 2 * 300 mAh Working time: 120 min Charging time: 70 min
Adapter		Input: 100 – 240 V, 50 – 60 Hz Output: 5 V, 1000 MA

OPERATING INSTRUCTIONS

Important!

The shaver was not charged at the factory. Please charge the shaver at least 5 hours before the first use to achieve maximum performance.

Charging method

1. Remove the shaver and charger from the box.
2. Plug the charger into an outlet.
3. Make sure that the switch is in the "OFF" position, then start charging.
4. The red charging indicator will light up indicating the charge status.

If the appliance will not be used for a long time, store it in a safe, cool, dry place. Do not wrap the cord tightly around the shaver. Do not hang the shaver by the power cord.

Replacement of the knife block

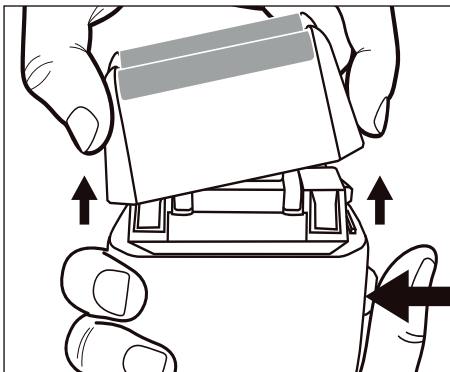

1. Remove the cutting head by pressing the round lock button located on the right side of the shaver. Grasp the cutting head on both sides and carefully remove it from the shaver.
2. Place the replacement nets over the knives. Be careful not to damage the foil. Gently place the cutting head on the shaver and push until it snaps.

Replacement of knives

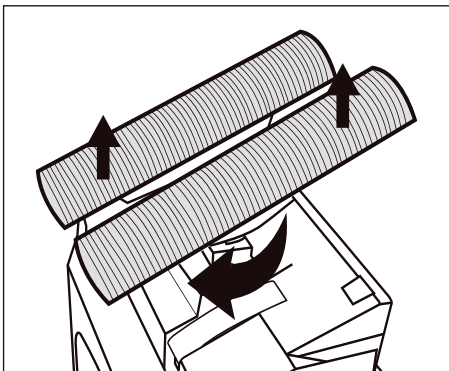

1. Remove the cutting head by pressing the lock button located on the right side of the shaver. Grasp the cutting head on both sides and carefully remove it from the shaver.
2. To remove the knife block, grasp it from both sides and gently press, turn it 90° degrees. To install a new knife block, hold it on both sides and align the metal shaft on the underside with the notch on the razor drive. Gently push down and turn until it snaps.

Cleaning the knife block

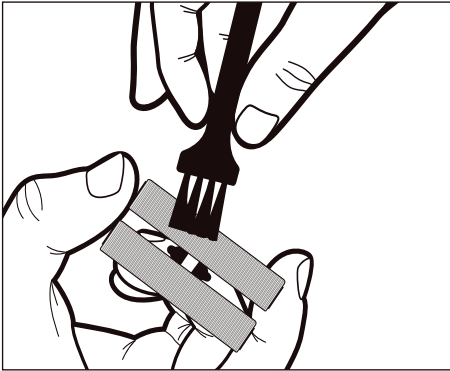

1. Gently tap the base of the cutting head on a flat surface so that the hairs inside fall out.
3. Brush the hair from the knives. If necessary, you can remove them from the razor for better cleaning.
4. Install the cutting head on the shaver.

WARNING!

In case of a malfunction, do not attempt to repair the device yourself. Contact the manufacturer immediately! There are no user serviceable parts in this appliance.

IMPORTANT SAFETY RECOMMENDATIONS

Before using, read the instructions for the basic precautions that should always be followed when using electrical appliances.

Please note that electrical appliances are charged even when switched off to prevent harm and reduce the risk of electric shock:

- Always disconnect the appliance from the mains immediately after use.
- Do not use the device while bathing.
- Do not store or place the device near water or other liquids.
- Do not store or place the device where it may fall.
- Do not immerse the device in water or other liquids.
- If the device falls into the water, disconnect it from the mains immediately. **DO NOT** put your hand in the water to get it.

WARNING

To reduce the risk of injury, burns, fire or electric shock:

- Do not leave the appliance plugged into an outlet unattended.
- Do not allow the tool to be used by children and persons who have difficulty handling electrical appliances.

• Use this device only for its intended purpose, as described in this manual.

DO NOT use attachments not recommended by the manufacturer.

- Keep the cord away from heated surfaces.

DO NOT pull, twist or wrap the cord around the appliance even when storing.

- **DO NOT** use outdoors.
- **DO NOT** direct aerosol products or oxygen to the appliance.
- Do not place the device on any surface while it is in operation.
- Always turn off the device and disconnect it from power sources before cleaning.
- Always turn off the device and disconnect it from power sources immediately after use.
- Keep the hair away from the inlet holes while working.